

DWG. NO.

REVISIONS			
REV.	DESCRIPTION	APPROVED	DATE

ATP-I-010-Q-219 revA
6.5 turn

← .0340 →

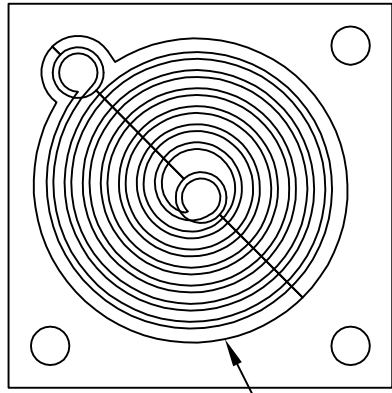

↑ .0340 ↓

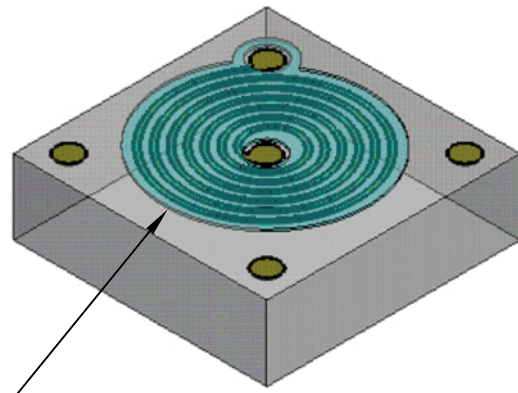

- NOTES: (UNLESS OTHERWISE SPECIFIED)
- MATERIAL: .010 THK QUARTZ/FUSED SILICA (SiO₂)
 - METALIZATION A SIDE
TiW= 400-800 Å°
Au= 250 uin min.
NO METALIZATION ON B SIDE
 - CRITICAL DIMENSIONS:
LINE= .0006±.0001
GAP= .001±.0001
POLYIMIDE=3-6 MICRONS



ITEM	QTY	PART/MATERIAL - DESCRIPTION	MATL-DWG NO.	MATL-SPEC
PARTS LIST				
CAD GENERATED DRAWING. DO NOT MANUALLY UPDATE				
APPROVALS		DATE	 ATP APPLIED THIN-FILM PRODUCTS 3438 EDISON WAY FREMONT, CALIFORNIA 94538 6.5 TURN 21.9nh SPIRAL INDUCTOR	
DRAWN	BKL	01/10/13		
MFG	A.Nackey	02/07/13		
QA	K.Netser	02/07/13		
DOC CNTRL	C.Quesada	02/07/13	TITLE	
SIZE		CAGE CODE	DWG. NO.	REV
B		04ZMO	ATP-I-010-Q-219	A
SCALE		SHEET		1 OF 1